

REPLACEMENT AND INSTALLATION INSTRUCTIONS FOR NEW URETHANE BUSHING ASSEMBLIES

NEW ASSEMBLIES

1. Inspect to make certain all bushings are flush and fully seated against face side of coupling flange.
2. Install and align coupling within $\pm 1/2^\circ$.
3. Equipment is ready to run.

REPLACEMENT BUSHINGS

1. Remove old bushing and bearing assembly.
2. Press new bushing in place - bushing may be a loose slide fit due to cleaning hole when removing old assembly; this is acceptable.
3. Re-install and align coupling within $\pm 1/2^\circ$.
4. Equipment is ready to run.

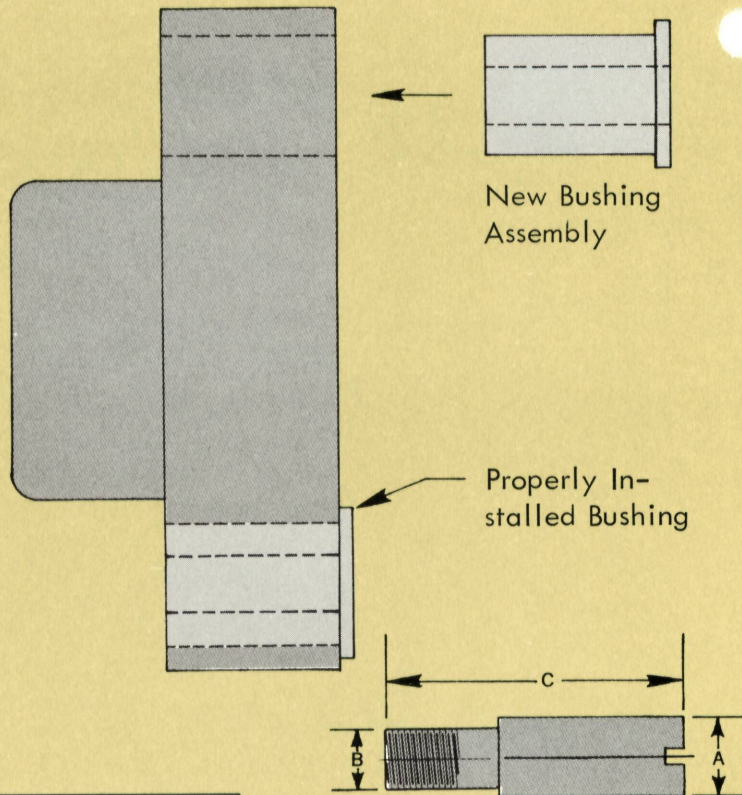

SPECIFICATIONS										
SIZE	AJAX STUDS				AJAX BUSHINGS				FIT AJAX COUPLING SIZES	
	A	B	C	Weight per doz. (lbs.)	A	B	D	L		Weight per doz. (oz.)
3	7/16"	5/16"	1-3/8"	1	1-1/16	7/16	15/16	5/8	3.3	3/4A, Type E, F-3, 3/4H, 423, 412
4	9/16"	3/8"	1-25/32"	2	1-1/4	9/16	1-1/8	3/4	5.3	1A, 1-1/4A, 1H, 1-1/4H, F-5, F-7, F-9, 1S, 523, 417
4-1/2	5/8"	3/8"	2-5/16	3	1-3/8	5/8	1-1/4	1	9.0	2S, 1-1/2S, 422
5	3/4"	1/2"	2-17/32"	4	1-1/2	3/4	1-3/8	1-1/8	11.5	1-3/8A, 1-1/2A, 1-3/4A, 2-1/2S, 427
6	13/16"	9/16"	3-1/32"	6	1-3/4	13/16	1-5/8	1-3/8	20.5	2A, 2-3/8A, 3S
7	7/8"	5/8"	3-17/32"	8	2	7/8	1-7/8	1-5/8	33.5	2-3/4A, 3-1/8A, 3-1/2S
8	1"	3/4"	4-1/32"	11	2-1/8	1	2	1-7/8	52.5	3-5/8A, 4A, 4-1/2A, 5A, 5-1/2A, 4S
9	1-1/8"	7/8"	5-1/16"	18	2-3/8	1-1/8	2-1/4	2-3/8	66.8	6A, 4-1/2S
10	1-1/4"	1"	6-5/32"	28	2-5/8	1-1/4	2-1/2	2-7/8	98.7	6-1/2A, 5S, 6S
10-1/2	1-1/4"	1"	6-5/32"	28	Consult Ajax for Larger Sizes				7-1/2A (Old Style)	
11	1-1/2"	1-1/4"	7-1/8"	33					7-1/2A, 7S, 9-1/2A (Old Style)	
12	1-1/2"	1-1/4"	8-1/8"	50					8S, 9-1/2A (New Style)	
13	1-1/2"	1-1/4"	10-1/8"	65					12a	

AJAX STUDS

NOTES:

1. Nuts and lockwashers are supplied with studs.
2. Check dimensions carefully when placing orders for parts.

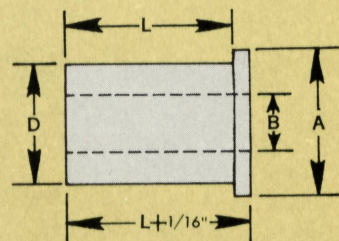

AJAX BUSHING ASSEMBLIES

NOTE:

Please furnish coupling size and serial number when ordering any parts.

RENOLD AJAX INC.

POWER TRANSMISSION DIVISION

P.O. BOX A · WESTFIELD · NEW YORK 14787

Telephone 716-326-3121

Telex 91-203